

# HOLLYWOOD FLAT

- Frame perpendicular to paint surface
- Can be soft or hard covered, most often hard (usually lauan)
- Easier to attach to a floor than a Broadway flat

Hollywood Flat

TRDA Scenic Lab

Hollywood flat

Scale:

Date Drawn:

Date Completed:

1-1/2" = 1'

Director:

Designer:

Draftsman:

N/A

N/A

Abby Bender

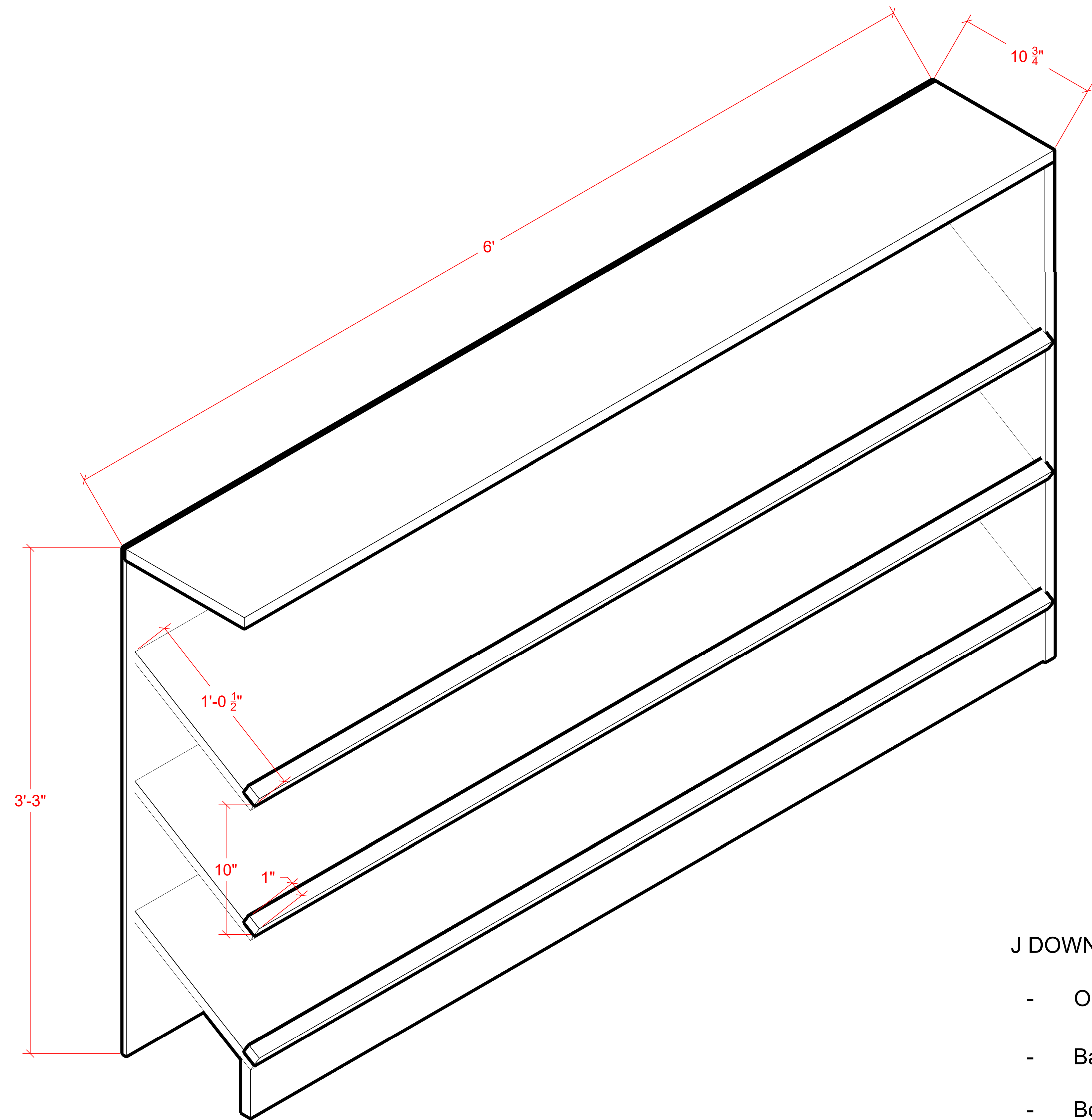

J DOWN SHOE RACK IDEA

- One side removed to show idea better- would be fully enclosed
- Back is currently  $\frac{1}{4}$ " material- could be lauan, could be maso
- Bottom fully enclosed to prevent small items getting kicked underneath
- Angled for ease of placing/grabbing shoes at beginning and end of class
- 10 inches between shelves to avoid squished fingers
- Can hold 21-24 pairs of shoes, width of shoes depending
- The idea is it would fit in that little alcove as you enter J from the lobby, between the railing and the post/cinder brick building support

N/A	Scale:	3" = 1'	Director:	N/A	1
J Down	Date Drawn:	12/6/2022	Designer:	Abby Bender	
Shoe Rack	Date Completed:		Draftsman:	Abby Bender	

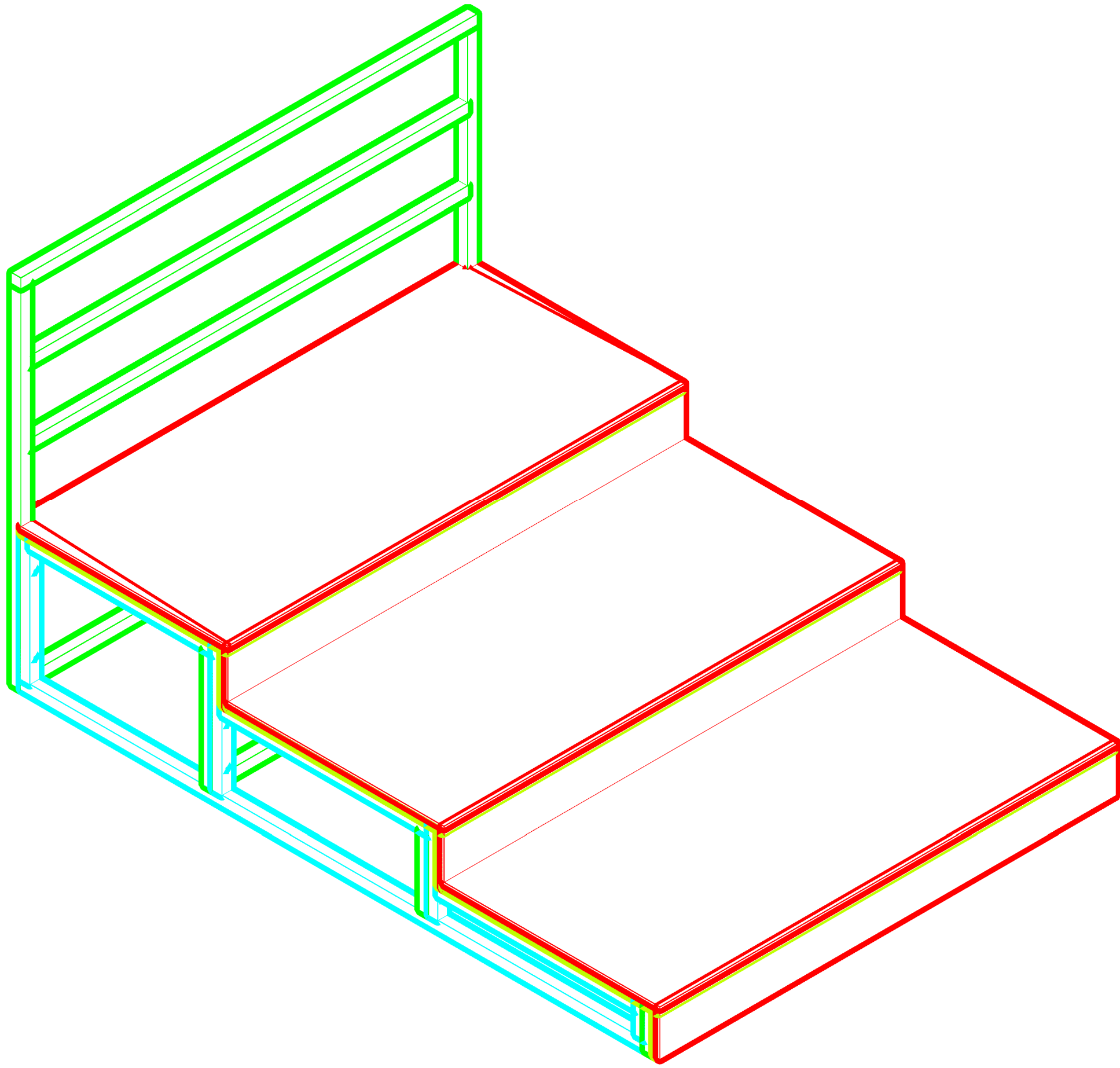

XX 202 Seating Unit

Note: Each piece of plywood + carpet (yellow + red) are different, and are labeled A (bottom step), B (middle), and C (top step)

We have enough stock in the breezeway to make 10 of these, standard room setup is 4-5

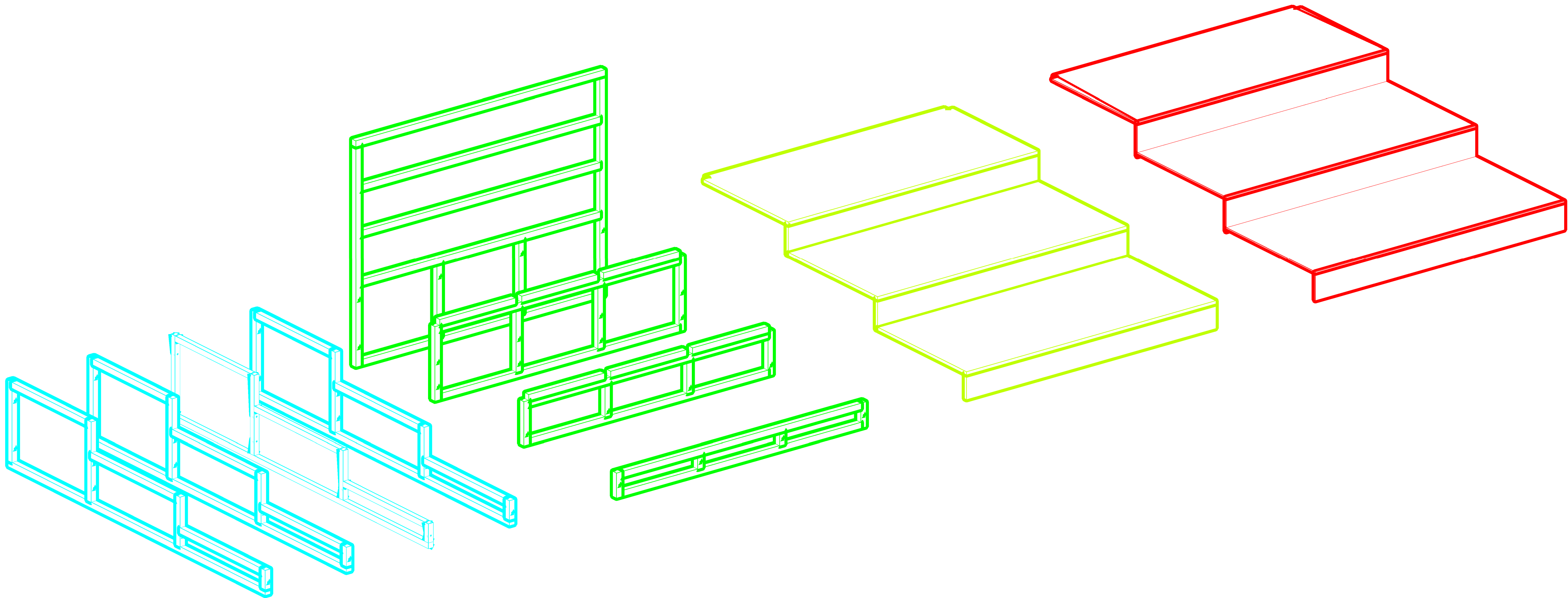

NA XX Black Box Seating Unit	Scale:	NTS	Director:	Director Name	1
	Date Drawn:	Date Drawn	Designer:	Designer Name	
	Date Completed:		Draftsman:	Abby Bender	